

### Fan-Cooled Vacuum / Pressure Pump

## VK650

- ◆ **Integrated Inlet Filter**
  - Includes washable stainless steel filter for long filter life.
  
- ◆ **Integrated Oil Tank**
  - No need for an external oil tank.
  - Holds up to 1 Gallon Masport Vacuum Pump Oil.
  
- ◆ **Integral Valve**
  - Allows pump to operate in vacuum and pressure mode.
  - Posi-Lock handle for secure positioning.
  
- ◆ **Automatic Oil Pump**
  - No adjustment required.
  - Delivers the right amount of oil at all working levels.
  
- ◆ **End Thrust Protection**
  - Cushioned spring washer design.
  - Prevents rotor-to-endcover contact created by direct P.T.O. drive or misaligned belt driven systems.



- ◆ **Masport Quality & Performance**
  - 23" Hg Continuous, 27" Hg Intermittent.
  - Precise machining and assembly.
  - Heavy Duty Bearings.
  - Viton Oil Seals for longer service life.
  - Fan-Cooled for higher continuous vacuum operations.
  - Flushing Port.
  - Vane Inspection Port.
  - Superior pump life.
  
- ◆ **Performance Warranty**
  - One Year Warranty.

# PERFORMANCE DATA

## Performance Data – Vacuum

Pump R.P.M.	Displacement C.F.M.	S.C.F.M. & A.C.F.M. @ VACUUM											Vacuum- "Hg	
		5	10	15	18	20	22	24	25	26	27	Continuous	Intermittent	
1200	343	SCFM	247	187	132	100	81	60	42	22	13	5	22	27
		ACFM	297	282	264	250	246	229	214	136	101	50		
1400	377	SCFM	282	215	152	117	94	67	48	24	15	5.5	20	27
		ACFM	340	326	304	293	285	259	241	152	112	55		

## Performance Data – Pressure

Pump R.P.M.	Displacement C.F.M.	S.C.F.M. @ P.S.I.G.							Maximum Pressure – P.S.I.G.	
		5	10	15	18	20	25	30	Continuous	Intermittent
1200	343	285	251	244	239	233	230	215	20	30
1400	377	313	297	283	279	275	270	251	20	30

## Horsepower Required @ P.S.I.G.

Pump R.P.M.	P.S.I.G.					
	5	10	15	20	25	30
1000	16	17	21	25	29	32
1200	20	22	26	30	35	38
1400	25	27	31	36	40	45

## Horsepower Required @ "Hg

Pump R.P.M.	Vacuum "Hg				
	5	10	15	20	27
1000	11	11	11	12	12
1200	15	15	15	15	15
1400	19	19	19	19	19

# DIMENSIONAL DATA

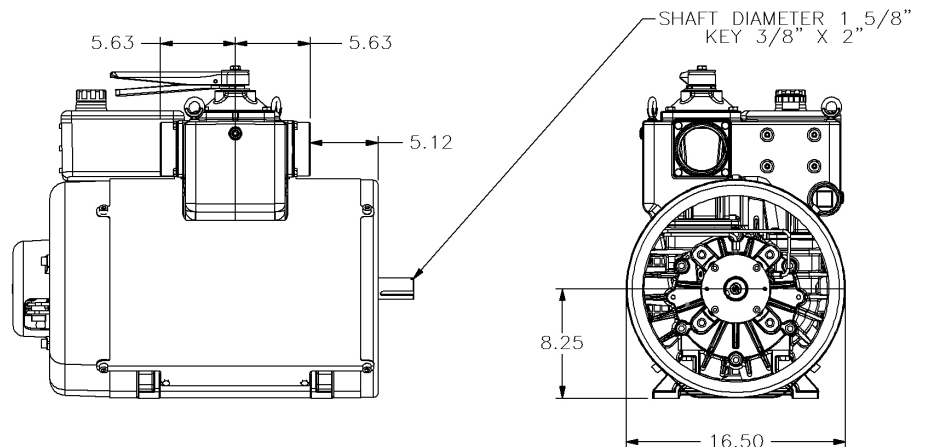
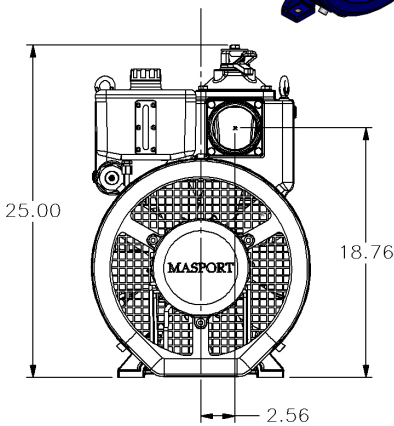
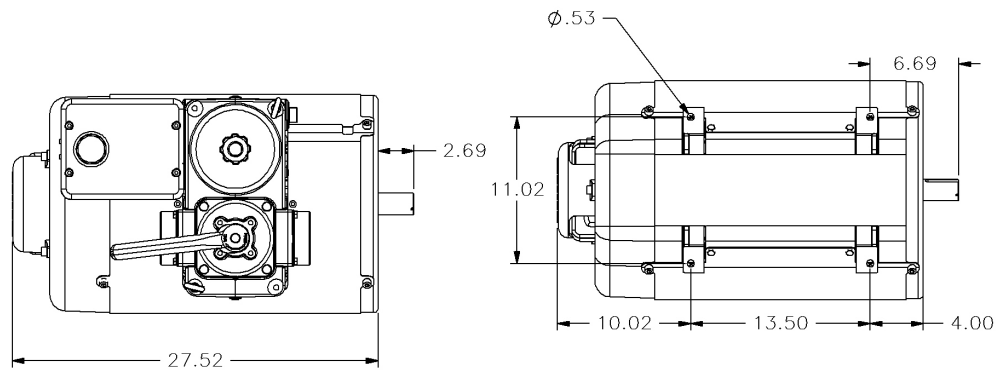
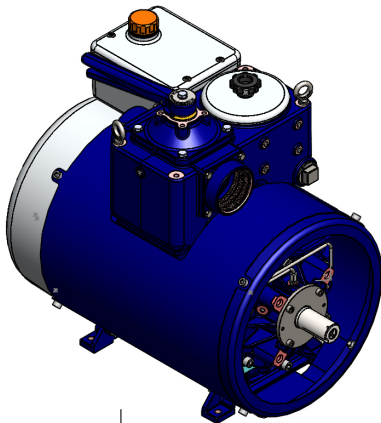

**MASPORT INCORPORATED**

6801 Cornhusker Hwy.

Lincoln, Nebraska 68507

402-466-8428 FAX: 402-466-8355

www.masportpump.com

**CALL TOLL FREE 800-228-4510**